

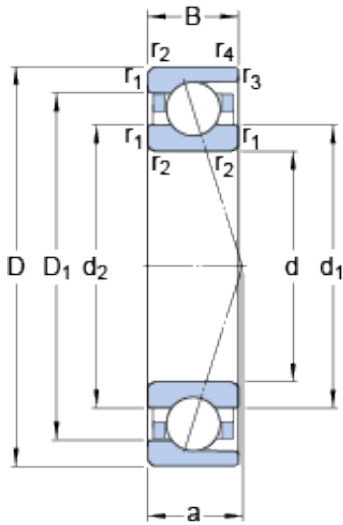

NTN DRIVESHAFT ANDERSON, INC.



105 mm x 145 mm x 20 mm SKF 71921
CD/P4A angular contact ball bearings

Bearing No. 71921 CD/P4A

71921 CD/P4A Bearing 2D drawings and 3D CAD models

Size	145x105x20 mm
Bore Diameter	145 mm
Outer Diameter	105 mm
Width	20 mm
d	105 mm
D	145 mm
B	20 mm
d ₁	117.3 mm
d ₂	117.3 mm
D ₁	132.7 mm
r _{1,2} - min.	1.1 mm
r _{3,4} - min.	0.6 mm
a	26.8 mm
d _a - min.	111 mm
d _b - min.	111 mm
D _a - max.	139 mm
D _b - max.	141 mm
r _a - max.	1 mm
r _b - max.	0.6 mm
d _n	120.6 mm
Basic dynamic load rating - C	61.8 kN
Basic static load rating - C ₀	69.5 kN
Fatigue load limit - P _u	2.6 kN
Limiting speed for grease	8500 r/min



NTN DRIVESHAFT ANDERSON, INC.

Lubrication	
Limiting speed for oil lubrication	14000 mm/min
Ball - D_w	12.7 mm
Ball - z	27
G_{ref}	11.1 cm ³
Calculation factor - f_0	16.4
Preload class A - G_A	230 N
Preload class B - G_B	460 N
Preload class C - G_C	920 N
Preload class D - G_D	1840 N
Calculation factor - f	1.25
Calculation factor - f	1
Calculation factor - f_{2A}	1
Calculation factor - f_{2B}	1.04
Calculation factor - f_{2C}	1.09
Calculation factor - f_{2D}	1.15
Calculation factor - f_{HC}	1
Preload class A	110 N/micron
Preload class B	151 N/micron
Preload class C	215 N/micron
Preload class D	316 N/micron
d_1	117.3 mm
d_2	117.3 mm
D_1	132.7 mm
$r_{1,2}$ min.	1.1 mm
$r_{3,4}$ min.	0.6 mm
d_a min.	111 mm
d_b min.	111 mm
D_a max.	139 mm



NTN DRIVESHAFT ANDERSON, INC.

D_b max.	141 mm
r_a max.	1 mm
r_b max.	0.6 mm
d_n	120.6 mm
Basic dynamic load rating C	61.8 kN
Basic static load rating C_0	69.5 kN
Fatigue load limit P_u	2.6 kN
Attainable speed for grease lubrication	8500 r/min
Attainable speed for oil-air lubrication	14000 r/min
Ball diameter D_w	12.7 mm
Number of balls z	27
Reference grease quantity G_{ref}	11.1 cm ³
Preload class A G_A	230 N
Static axial stiffness, preload class A	110 N/ μ m
Preload class B G_B	460 N
Static axial stiffness, preload class B	151 N/ μ m
Preload class C G_C	920 N
Static axial stiffness, preload class C	215 N/ μ m
Preload class D G_D	1840 N
Static axial stiffness, preload class D	316 N/ μ m
Calculation factor f	1.25
Calculation factor f_1	1
Calculation factor f_{2A}	1
Calculation factor f_{2B}	1.04
Calculation factor f_{2C}	1.09
Calculation factor f_{2D}	1.15
Calculation factor f_{HC}	1



NTN DRIVESHAFT ANDERSON, INC.

Calculation factor f_0	16.4
Mass bearing	0.82 kg