

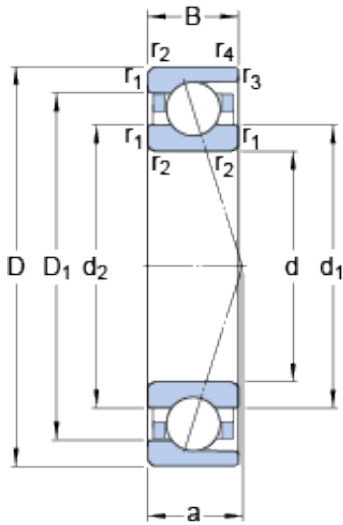

NTN DRIVESHAFT ANDERSON, INC.



340 mm x 460 mm x 56 mm SKF 71968
CDMA/P4A angular contact ball bearings

Bearing No. 71968 CDMA/P4A

71968 CDMA/P4A Bearing 2D drawings and 3D CAD models

Size	460x340x56 mm
Bore Diameter	460 mm
Outer Diameter	340 mm
Width	56 mm
d	340 mm
D	460 mm
B	56 mm
d ₁	377 mm
d ₂	377 mm
D ₁	423 mm
r _{1,2} - min.	3 mm
r _{3,4} - min.	1.1 mm
a	81.8 mm
d _a - min.	353 mm
d _b - min.	353 mm
D _a - max.	445 mm
D _b - max.	454 mm
r _a - max.	2.5 mm
r _b - max.	1 mm
d _n	387 mm
Basic dynamic load rating - C	390 kN
Basic static load rating - C ₀	670 kN
Fatigue load limit - P _u	14.3 kN
Limiting speed for grease	2400 r/min



NTN DRIVESHAFT ANDERSON, INC.

Lubrication	
Limiting speed for oil lubrication	4000 mm/min
Ball - D_w	38.1 mm
Ball - z	29
G_{ref}	294 cm ³
Calculation factor - f_0	16.6
Preload class A - G_A	1460 N
Preload class B - G_B	2920 N
Preload class C - G_C	5840 N
Preload class D - G_D	11680 N
Calculation factor - f	1.27
Calculation factor - f	1
Calculation factor - f_{2A}	1
Calculation factor - f_{2B}	1.04
Calculation factor - f_{2C}	1.09
Calculation factor - f_{2D}	1.15
Calculation factor - f_{HC}	1
Preload class A	300 N/micron
Preload class B	408 N/micron
Preload class C	571 N/micron
Preload class D	827 N/micron
d_1	377 mm
d_2	377 mm
D_1	423 mm
$r_{1,2}$ min.	3 mm
$r_{3,4}$ min.	1.1 mm
d_a min.	353 mm
d_b min.	353 mm
D_a max.	445 mm



NTN DRIVESHAFT ANDERSON, INC.

D_b max.	454 mm
r_a max.	2.5 mm
r_b max.	1 mm
d_n	387 mm
Basic dynamic load rating C	390 kN
Basic static load rating C_0	670 kN
Fatigue load limit P_u	14.3 kN
Attainable speed for grease lubrication	2400 r/min
Attainable speed for oil-air lubrication	4000 r/min
Ball diameter D_w	38.1 mm
Number of balls z	29
Reference grease quantity G_{ref}	294 cm ³
Preload class A G_A	1460 N
Static axial stiffness, preload class A	300 N/ μ m
Preload class B G_B	2920 N
Static axial stiffness, preload class B	408 N/ μ m
Preload class C G_C	5840 N
Static axial stiffness, preload class C	571 N/ μ m
Preload class D G_D	11680 N
Static axial stiffness, preload class D	827 N/ μ m
Calculation factor f	1.27
Calculation factor f_1	1
Calculation factor f_{2A}	1
Calculation factor f_{2B}	1.04
Calculation factor f_{2C}	1.09
Calculation factor f_{2D}	1.15
Calculation factor f_{HC}	1



NTN DRIVESHAFT ANDERSON, INC.

Calculation factor f_0	16.6
Mass bearing	25.5 kg