

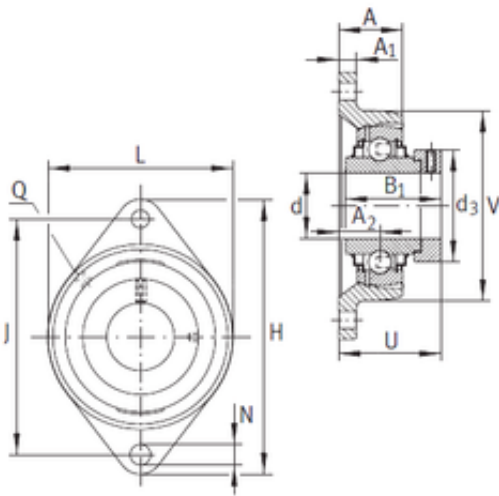

NTN DRIVESHAFT ANDERSON, INC.

INA LCJT50-N bearing units



LCJT50-N Bearing 2D drawings and 3D CAD models

Bearing No. LCJT50-N

Bore Diameter	50 mm
d	50 mm
V	116 mm
U	66,2 mm
Thread (Q)	Rp1/8
d3	69 mm
A	39 mm
A1	13 mm
B1	62,8 mm
H	190 mm
J	157 mm
L	116 mm
N	18 mm
A2	28 mm
Weight	2,21 Kg
Basic dynamic load rating (C)	35 kN
Category	Flange Block Bearings
Inventory	0.0
Manufacturer Name	SCHAEFFLER GROUP
Minimum Buy Quantity	N/A
Weight / Kilogram	2.682
EAN	4012802802498
Product Group	M06110
Number of Mounting Holes	2
Mounting Method	Eccentric Collar
Housing Style	2 Bolt Flange Block



NTN DRIVESHAFT ANDERSON, INC.

Rolling Element	Ball Bearing
Housing Material	Cast Iron
Expansion / Non-expansion	Non-expansion
Mounting Bolts	18 Millimeter
Relubricatable	Yes
Insert Part Number	GE50-KLLHB
Seals	Double Labyrinth
Housing Configuration	1 Piece Solid
Pilot Configuration	No Pilot
Inch - Metric	Metric
Long Description	2 Bolt Flange Block; 50MM Bore; 157MM Bolt Circle; 157MM Bolt Spacing; 1 Piece Solid; Eccentric Collar Mount; Cast Iron; Ball Bearing; 62.7MM Length Thru Bore; Relubricatable; Double Labyrinth Seal
Other Features	Single Row Radial Metric With Set Screw
Category	Flange Block
UNSPSC	31171501
Harmonized Tariff Code	8483.20.40.40
Noun	Bearing
Keyword String	Flanged
Manufacturer URL	http://www.ina.com
Manufacturer Item Number	LCJT50
Weight / LBS	5.513
Nominal Bolt Circle Diameter Round	6.2 Inch 157 Millimeter
Cartridge Pilot Diameter	0 Inch 0 Millimeter
Bolt Spacing	6.181 Inch 157 Millimeter
Bore	1.969 Inch 50 Millimeter
Length Thru Bore	2.469 Inch 62.7 Millimeter