

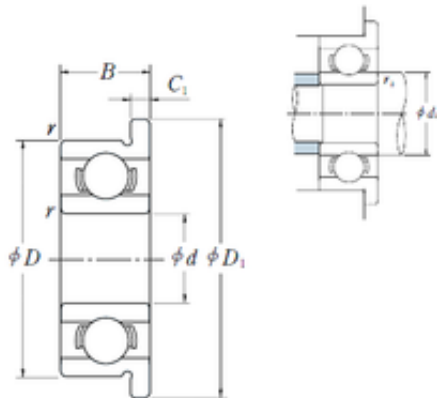

# NTN DRIVESHAFT ANDERSON, INC.



2,5 mm x 7 mm x 2,5 mm NSK F692X deep groove ball bearings

Bearing No. F692X

F692X Bearing 2D drawings and 3D CAD models

|                               |                |
|-------------------------------|----------------|
| Size                          | 2.5x8.5x2.5 mm |
| Bore Diameter                 | 2,5 mm         |
| Outer Diameter                | 8,5 mm         |
| Width                         | 2,5 mm         |
| d                             | 2,5 mm         |
| D                             | 7 mm           |
| D1                            | 8,5 mm         |
| B                             | 2,5 mm         |
| r min.                        | 0,15 mm        |
| C1                            | 0,7 mm         |
| da min.                       | 3,7 mm         |
| ra max.                       | 0,15 mm        |
| Weight                        | 0,51 Kg        |
| Basic dynamic load rating (C) | 385 kN         |
| Basic static load rating (C0) | 127 kN         |
| (Grease) Lubrication Speed    | 63000 r/min    |
| SRI                           | 0.67           |
| hidYobi                       | F692X          |
| LangID                        | 1              |
| D_                            | 7              |
| SREX                          | 0.02           |
| C                             | 0.385          |
| B_                            | 2.5            |
| hidTable                      | ecat_NSESBMF   |
| C0r                           | 13             |



## NTN DRIVESHAFT ANDERSON, INC.

|            |              |
|------------|--------------|
| Oil rpm    | 75000        |
| SRE        | 0.67         |
| mass       | 0.51         |
| GRS rpm    | 63000        |
| ra         | 0.15         |
| SRIX       | 0.02         |
| Cr         | 39           |
| SRIN       | 0            |
| C_1        | 0.7          |
| C0         | 0.127        |
| fo         | 12.599       |
| SREN       | 0            |
| D_1        | 8.5          |
| DE_        | 5.95         |
| Prod_Type3 | ESM_MD_WF_OT |
| da         | 3.7          |
| DA_        | 1.2          |
| Z_         | 7            |
| yobi       | F692X        |
| SDM_       | 4.75         |
| r          | 0.15         |
| KBRG       | 6102         |
| DI_        | 3.55         |
| B0         | 2.5          |