

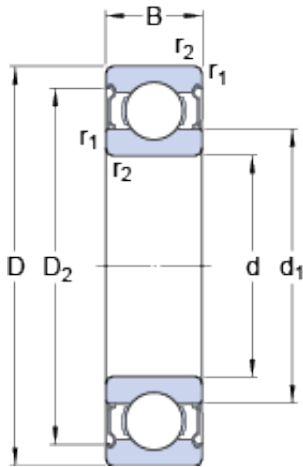

# NTN DRIVESHAFT ANDERSON, INC.



19.05 mm x 41.275 mm x 11.113 mm SKF D/W R12-2Z deep groove ball bearings

Bearing No. D/W R12-2Z

D/W R12-2Z Bearing 2D drawings and 3D CAD models

Size	41.275x19.05x11.113 mm
Bore Diameter	41,275 mm
Outer Diameter	19,05 mm
Width	11,113 mm
d	19.05 mm
D	41.275 mm
B	11.113 mm
d <sub>1</sub>	27.6 mm
D <sub>2</sub>	37.43 mm
r <sub>1,2</sub> - min.	0.8 mm
d <sub>a</sub> - min.	24.5 mm
D <sub>a</sub> - max.	37.5 mm
r <sub>a</sub> - max.	0.8 mm
Basic dynamic load rating - C	8.1 kN
Basic static load rating - C <sub>0</sub>	5 kN
Fatigue load limit - P <sub>u</sub>	0.212 kN
Reference speed	38000 r/min
Limiting speed	19000 r/min
Calculation factor - k <sub>r</sub>	0.03
Calculation factor - f <sub>0</sub>	13.9
d <sub>1</sub>	27.6 mm
D <sub>2</sub>	37.43 mm
r <sub>1,2</sub> min.	0.8 mm
d <sub>a</sub> min.	24 mm



## NTN DRIVESHAFT ANDERSON, INC.

$d_a$ max.	27.5 mm
$D_a$ max.	37.5 mm
$r_a$ max.	0.8 mm
Basic dynamic load rating C	8.06 kN
Basic static load rating $C_0$	5 kN
Fatigue load limit $P_u$	0.212 kN
Calculation factor $k_r$	0.03
Calculation factor $f_0$	13.9
Mass bearing	0.061 kg