

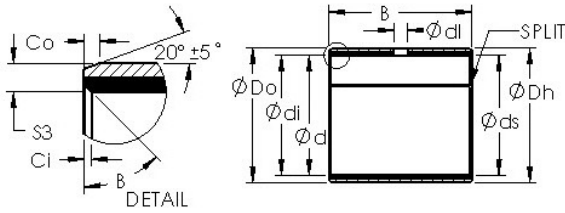

NTN DRIVESHAFT ANDERSON, INC.



AST AST11 1425 plain bearings

Bearing No. AST11 1425

Bore Diameter	14 mm
Outer Diameter	16 mm
Bearing Type	straight
Shaft Dia., Nominal (d)	14.0000
Shaft Size (ds) - 14 -0.016 / -0.034	14 0.016 / 0.034
Housing Bore Dia. (Dh)	16 +0.018 / +0
Bearing Outside Diameter, Nominal(Do)	16.000
Bearing Outside Diameter Tolerance (Do tol.)	16.065 / 16.03
Bearing Bore after Mounting (di)	14.058 / 13.99
Average Clearance (Cd)	0.0490
Wall Thickness (S3)	1.005
Bearing Length, Nominal (B)	25.000
Bearing Length Tolerance (B tol.) - +0 / -0.30	+0 / 0.30
OD Chamfer Length (Co)	0.600
ID Chamfer Angle (B deg.)	30
ID Chamfer Length (Ci)	0.300
Material	Bronze shell with PTFE / Fiber lining

AST11 1425 Bearing 2D drawings and 3D CAD models