

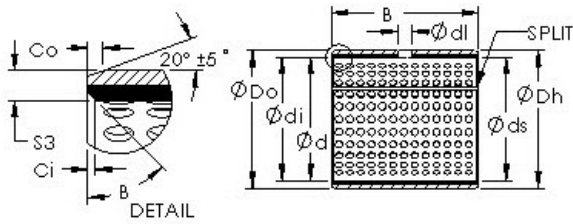

NTN DRIVESHAFT ANDERSON, INC.



AST AST20 20050 plain bearings

Bearing No. AST20 20050

| | |
|--|---|
| Bore Diameter | 200 mm |
| Outer Diameter | 205 mm |
| Bearing Type | straight |
| Shaft Dia., Nominal (d) | 200.0000 |
| Shaft Size (ds) - 200 +0 / -0.072 | 200 +0 / 0.072 |
| Housing Bore Dia. (Dh) - 205 +0.046 / -0 | 205 +0.046 / 0 |
| Bearing Outside Diameter, Nominal(Do) | 205.000 |
| Bearing Outside Diameter Tolerance (Do tol.) | 205.210 / 205.130 |
| Bearing Bore after Mounting (di) | 200.276 / 200.110 |
| Average Clearance (Cd) | 0.2250 |
| Wall Thickness (S3) | 2.418 |
| Bearing Length, Nominal (B) | 50.000 |
| Bearing Length Tolerance (B tol.) - +0 / -0.40 | +0 / 0.40 |
| OD Chamfer Length (Co) | 1.800 |
| ID Chamfer Angle (B deg.) | 45 |
| ID Chamfer Length (Ci) | 0.800 |
| Lube Hole Dia. (dl) | 9.500 |
| Material | Carbon steel shell with POM plastic liner |

AST20 20050 Bearing 2D drawings and 3D CAD models