

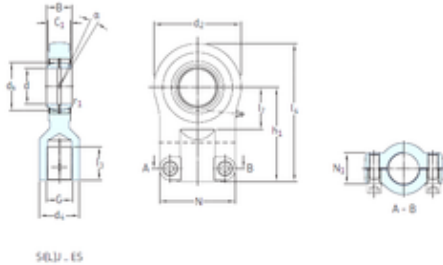

# NTN DRIVESHAFT ANDERSON, INC.

## SKF SIR35ES plain bearings



Bearing No. SIR35ES

Bore Diameter	35 mm
d	35 mm
d2	79 mm
d4 max.	41,5 mm
dk	47 mm
h1	70 mm
l3 min.	29 mm
l4 max.	110,5 mm
l7 min.	37 mm
r1 min.	0,6 mm
B	25 mm
C1 max	30,5 mm
N max	59 mm
N1 max	30,5 mm
Thread (G)	M28x1,5 Tolerance 6H
Angle	6 °
Weight	1,2 Kg
Basic dynamic load rating (C)	80 kN

SIR35ES Bearing 2D drawings and 3D CAD models