

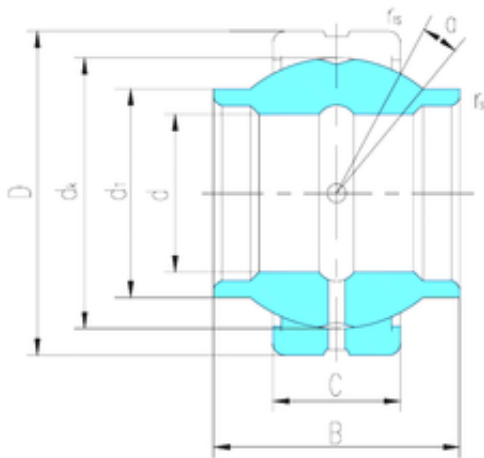

# NTN DRIVESHAFT ANDERSON, INC.



20 mm x 35 mm x 24 mm LS GEEM20ES-2RS  
plain bearings

Bearing No. GEEM20ES-2RS

Size	20x35x24 mm
Bore Diameter	20 mm
Outer Diameter	35 mm
Width	24 mm
d	20 mm
D	35 mm
B	24 mm
C	12 mm
d1	24 mm
dk	29 mm
r min.	0,3 mm
r1 min.	0,3 mm
Angle	6 °
Weight	0,072 Kg
Basic dynamic load rating (C)	30 kN

GEEM20ES-2RS Bearing 2D drawings and 3D CAD models