

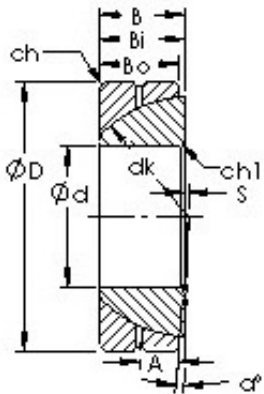

NTN DRIVESHAFT ANDERSON, INC.



AST GAC150S plain bearings

Bearing No. GAC150S

Size	150x225x48 mm
Bore Diameter	150 mm
Outer Diameter	225 mm
Width	48 mm
Bearing Type - steel-on-steel	steelonsteel
Bore Dia (d)	150.0000
Outer Dia (D)	225.0000
Width (B)	48.0000
Outer Width (Bo)	46.0000
Inner Width (Bi)	48.0000
Dynamic Load Rating (Cr)	850,000
Static Load Rating (Cor)	4,270,000
Max. shaft corner radius, or 45 deg. chamfer (ch1)	3.000
Max. housing corner radius, or 45 deg. chamfer (ch)	3.000
Spherical Diameter (dk or Dk)	211.000
Mis-alignment Angle (a deg.)	1
Lubrication Groove Location (A)	20.500
Spherical Center Location (S)	20
Weight (g)	8,010.00
Material	52100 Chrome steel, or equivalent

GAC150S Bearing 2D drawings and 3D CAD models