

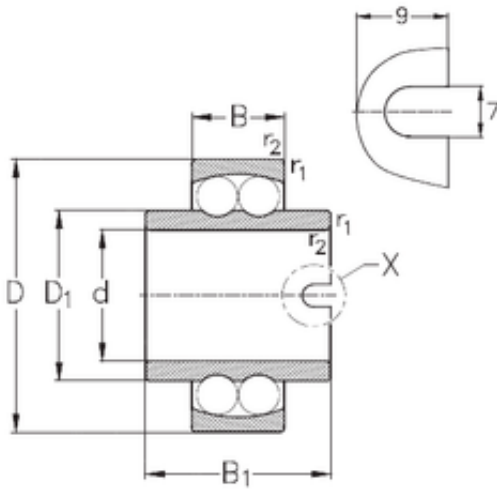

NTN DRIVESHAFT ANDERSON, INC.

35 mm x 72 mm x 52 mm NKE 11207 self aligning ball bearings



Bearing No. 11207

Size	35x72x52 mm
Bore Diameter	35 mm
Outer Diameter	72 mm
Width	52 mm
d	35 mm
D	72 mm
B	52 mm
C	17 mm
r1 min.	1,1 mm
r2 min.	1,1 mm
D1	47,7 mm
Weight	0,55 Kg
Basic dynamic load rating (C)	18,8 kN
Basic static load rating (C0)	5,9 kN

11207 Bearing 2D drawings and 3D CAD models