

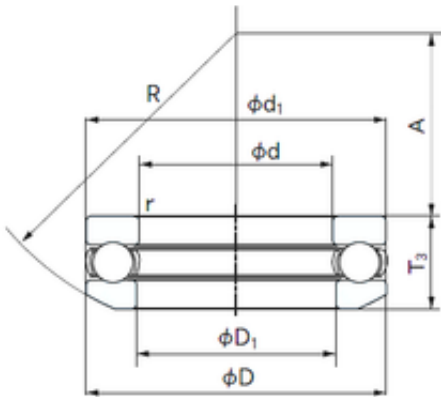

# NTN DRIVESHAFT ANDERSON, INC.

## NACHI 53216 thrust ball bearings

Bearing No. 53216



53216 Bearing 2D drawings and 3D CAD models

Size	80x115x29.5 mm
Bore Diameter	80 mm
Outer Diameter	115 mm
Width	29.5 mm
d	80 mm
D	115 mm
T	29.5 mm
d1	115 mm
r min.	1 mm
A	46 mm
D1	82 mm
R	90 mm
Weight	0.930 Kg
Basic dynamic load rating (C)	78,5 kN
Basic static load rating (C0)	219 kN
(Grease) Lubrication Speed	1700 r/min